

LEGEND FOR SITE PLAN

BLOCK -A	114) CO-OPERATIVE ROOM 115) PACKING MATERIAL DISPENSING AREA 116) STORE OFFICE 117) LIFT 118) PACKING MATERIAL STORE 119) PACKING STORE AREA 120) CLOAK ROOM 121) TOILET BLOCK 122) FINISHED STORE OFFICE 123) FINISHED STORE 124) CONTRACTOR STORE 125) GENERATOR ROOM 126) ARACHIS OIL TANK STORE ROOM 127) OFFICE 128) CHIEF ENGINEER OFFICE 129) MAINTENANCE STORE 130) MAINTENANCE CLOAK ROOM 131) MAINTENANCE SHOP FLOOR 131a) MOTOR BIKE STAND
BLOCK -D	132) PACKING MATERIAL STORE 133) SECURITY ROOM 134) STORE 135) WASH ROOM 136) W.C.
BLOCK -E	137) PASSAGE 138) EM. CONTROL CENTER-1 (SECURITY HRAD) 139) SECURITY OFFICER CHAMBER 140) VISITORS CHAMBER 141) W.C. 142) OCCUPATIONAL HEALTH CENTER 143) DOCTOR CHAMBER 144) L.T. PANEL ROOM 145) TRANSFORMER ROOM 146) VCB ROOM 147) C.E.S.C. METER ROOM 148) L.T. ROOM 149) CAPACITOR BANK 150) POOL WORKERS CLOAK ROOM 151) SECURITY CLOAK ROOM 152) WASH ROOM
BLOCK -F	153) MAINTENANCE STORE 154) CONTRACTOR ROOM 155) GENERATOR ROOM 156) EM. CONTROL CENTER-2 (UNION SAFETY OFFICER ROOM) 157) AMBULANCE GARAGE
BLOCK -B	53) MANAGER HR & ADMIN OFFICE (A.C) 54) PERSONAL MANAGER (A.C) 55) PERSONAL DEPARTMENT 56) OFFICE CABIN 57) ENTRANCE LOBBY 58) HR & ADMIN. OFFICE (A.C) 59) D.G. MANAGER OFFICE (A.C) 60) GENTS TOILET BLOCK 61) LIFT 62) R.C.C. STAIRCASE 63) PASSAGE 64) TABLET PACKING ROOM 65) TABLET STORE ROOM 66) GENERAL OFFICE (A.C) 67) SUPERVISOR OFFICE(A.C) 68) TABLET STRIP ROOM 69) SUPERVISOR ROOM 70) COMPRESSION ROOM 71) IPQC ROOM 72) BETALACTAM CHARGE ROOM 73) UTENSIL ROOM 74) CHANGE ROOM-1 75) CHANGE ROOM-2 76) GRANULATION ROOM 77) ELECTRIC ROOM 78) WASHING ZONE 79) DRYER ROOM 79a) FLUIDIZED BED DRYER ROOM 80) DAY STORE ROOM 81) CLOAK ROOM 82) STORE ROOM 83) AHU FILTER CLEANING ROOM 84) SCRAP ROOM 85) GENTS TOILET 86) LADIES TOILET 87) AHU ROOM 88) GRANULATION CHARGE ROOM 89) PUNCH ROOM 90) WASH ROOM 91) LUBRICATION ROOM 92) QUALITY STORE ROOM 93) TOOL ROOM 94) TABLET COMPRESSION ROOM 95) METAL DETECTOR ROOM 96) QUARANTINE ROOM 97) COATING ROOM 98) SERVICE ROOM
BLOCK -C	99) WASTAGE VAT 100) ROOM 101) ENTRANCE PASSAGE 102) PORCH 103) RAW MATERIAL OFFICE 104) RAW MATERIAL CLOAK ROOM 105) C.E.S.C. IN COMING ROOM 106) STORE 107) WASH ROOM 108) R.C.C. STAIRCASE 109) RA MATERIAL STORAGE AREA 110) NON-B LACTUM DISPENSING ROOM 111) REJECTED AREA 112) WASH ROOM 113) CAPSULE STORE ROOM)

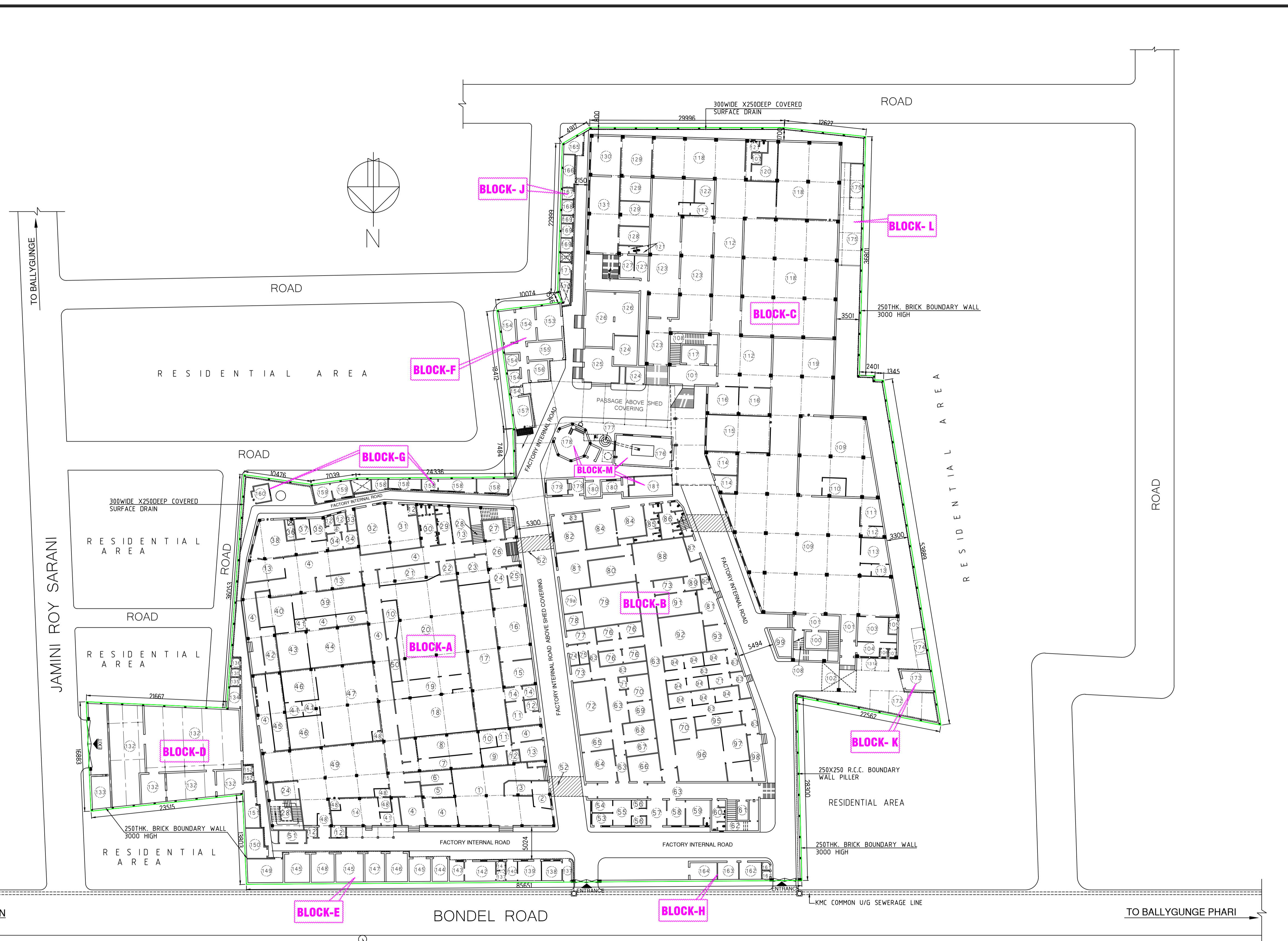

SITE PLAN (SCALE-1:300)
 NEAREST RLY. STN. FROM FACTORY (BALLYGUNGE) 1.5KM. APRX. FROM FACTORY
 NEAREST BUST STOP FROM FACTORY(BONDAL GATE) 0.5KM. APRX. FROM FACTORY

1. ALL DIMENSION ARE IN MM.
2. MAXIMUM NO. OF WORKERS ARE WORKING (MALE- 407 , FEMALE-23)
3. MANUFACTURING PRODUCT= PHARMACEUTICAL PRODUCTS
4. TOTAL NO. OF LATRINE-33 & URINAL-25 FOR MALE, LATRINE- 9 FOR FEMALE
5. ALL THE TOILET BLOCK ARE DIRECTLY CONNECTED TO KMC COMMON U/G SEWERAGE LINE
6. PRECINCT OF FACTORY PREMISES SHOWN IN GREEN COLOUR
7. PROPOSED CONSTRUCTION SHOWN IN BLACK COLOUR
8. SECTION LINE SHOWN IN BLUE COLOUR
9. PRESCRIBED STANDARD TYPE AND CAPACITY OF FIRE FIGHTING APPLIANCES/EQUIPMENT WILL BE PROVIDED MAINTAINED IN ACCORDANCE WITH LAID DOWN RULE 62 OF W.B. FACTORIES RULES 1958 (AMENDED UP TO DATE)
10. ALL THE DOORS ARE OPENABLE OUTWARD
11. W.C.- LATRINE

CLIENT:-
DEY'S MEDICAL STORES (MFG) LIMITED

ADDRESS:-
 62, BONDEL ROAD, KOLKATA-700019

SUBJECT:-
 SITE PLAN

DRAWN BY	PINAKI
CHECKED BY	JDY
APPROVED	
SCALE	1:300
DATE	29.07.2022
REV.	0
SHEET NO.	1 of 5

Consultant
SHEILA BANDHAB
 110a, College St. 4th, Floor, Room no-50
 Kolkata-700 072. (033)4649777